

## \*Feature:

- HALED patent optics design, similar to halogen light effect
- Easy and quick installation
- PF>0.9, flicker free, follows new ErP
- CRI 90
- Low UGR
- Peak luminous intensity 3200cd (24°) / 2150cd (36°)
- Metal appearance, excellent heat dissipation
- Lifespan 40000 hrs, 5 years warranty
- High energy efficiency
- DALI/ 1-10V optional

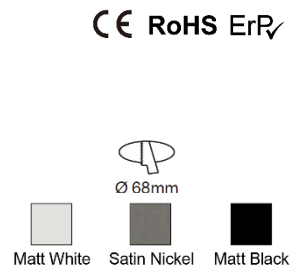

## Technical data

Part No.	Type of installation		
CTCA5411NWW/ N/ B	Recessed		
Electrical specifications			
Wattage (W)	11W	Power factor	0.9
AC input voltage (V)	AC200V-240V	Current	50mA
Frequency (Hz)	50/60Hz	DC output voltage (V)	DC32-40V
Flicker metric PST	0.033	Stroboscopic effect metric SVN	0.01
Total harmonic distortion (THD)	18%	Dimmable	No
Max. no. of lamps on B16A circuit breaker	250	Max. no. of lamps on C10A circuit breaker	160
Max. no. of lamps on C16A circuit breaker	250		
Photometric specifications			
Color temperature (CCT)	3000K±150K	CRI/ R9	90/ >60(Min.)
Chromaticity coordinate (x/ y)	0.44/ 0.403	Standard deviation of colour	≤3 SDCM
Useful luminous flux (lm)	800lm± 5%	Luminous efficiency (lm/W)	72lm/ W
UGR	≤19		

## Photometric Information

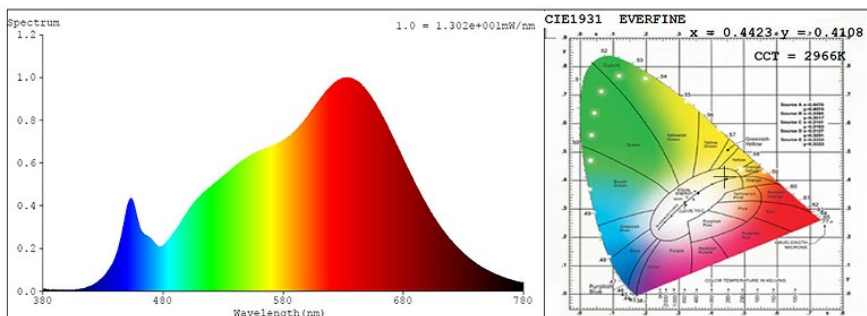

EAN	Colour	Beam angle	Peak Luminous intensity		
41217	Matt White	24°	2450cd		
41221	Stain Nickel	24°	2450cd		
41225	Matt Black	24°	2450cd		
41012	Matt White	36°	1850cd		
41189	Stain Nickel	36°	1850cd		
41193	Matt Black	36°	1850cd		

### Mechanical specifications

Housing material	Aluminium
Optical cover/ lens material	AlReflector+PC+Glass
Height	45mm
Product weight	220g

### Lifespan

Number of switching cycles	100,000-
L80/B10 service life at 25°C	40,000 hrs
Warranty	5 Years

### Application parameters

Working temperature range	-20~+50°C
---------------------------	-----------

### Package

Individual package length	130mm
Individual package height	68mm
Individual package width	130mm
Gross weight (single item)	240g
Driver	separated

Housing Colour	Matt White / Stain Nickel / Matt Black
----------------	---

Length/ diameter	85mm
------------------	------

Hole size	68mm
-----------	------

L70/B50 service life at 25°C	50,000 hrs
------------------------------	------------

L90/B10 service life at 25°C	20,000 hrs
------------------------------	------------

Storage temperature range	-20~+70°C
---------------------------	-----------

Shipping box height	580mm
---------------------	-------

Shipping box height	156mm
---------------------	-------

Shipping box width	290mm
--------------------	-------

Packaging unit	20pcs
----------------	-------

Gross weight (Shipping box)	5.2kgs
-----------------------------	--------

### Technical Drawings (mm)

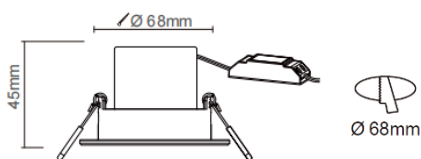

Package



85\*45mm



130\*110\*63mm



580\*290\*156mm(20PCS)

Cautions:

- Power off before replacement
- Do not in violation of any fire regulations when using
- Consult competent electricians for technical support
- If the supply cord is damaged, it shall be exclusively replaced by the manufacture or his service agent o similar qualified person in order to avoid a hazard

Installation /Mounting:

Please read the entire instruction manual before using the product and reserve it for future reference. We reserve the right for any error in text or image and any necessary change made to technical data. If you have any question regarding technical problems, please contact our Customer Services.

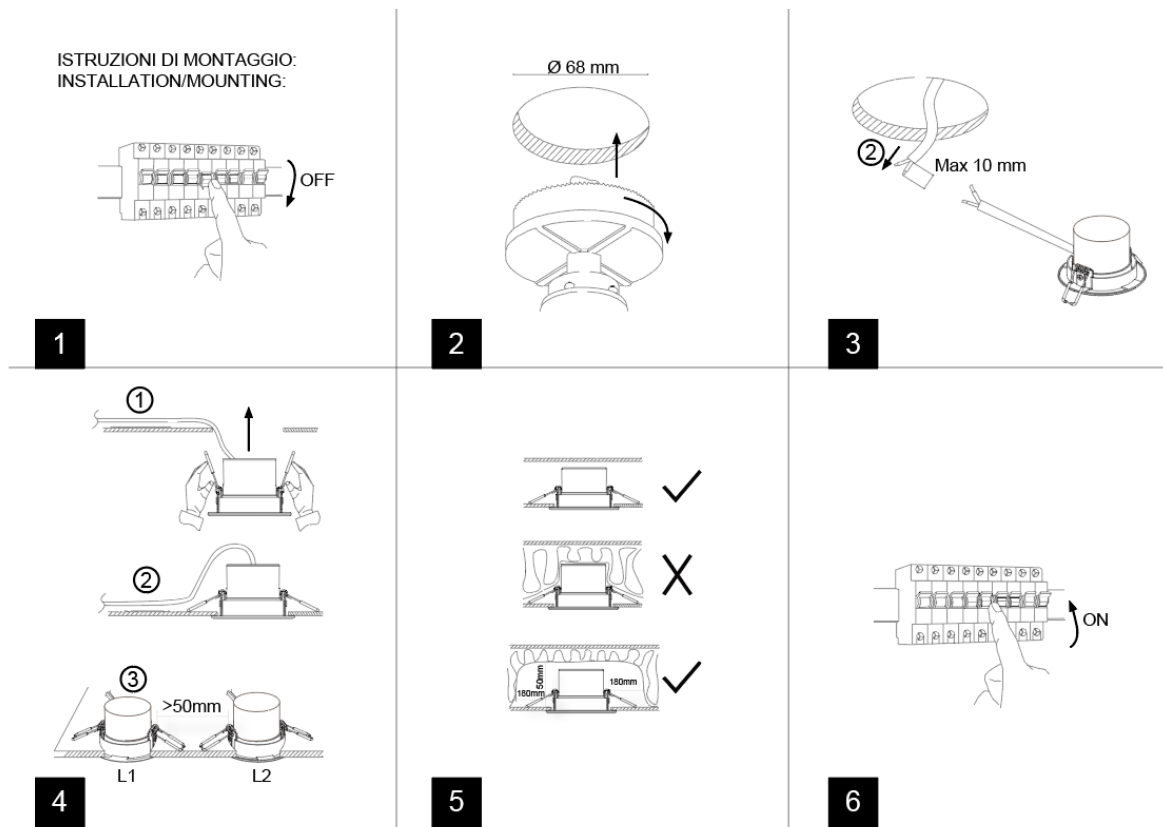

For non replacable lightsources. The light source of this luminaire is not replaceable; when the light source reaches its end of life, the whole luminaire shall be replaced"